

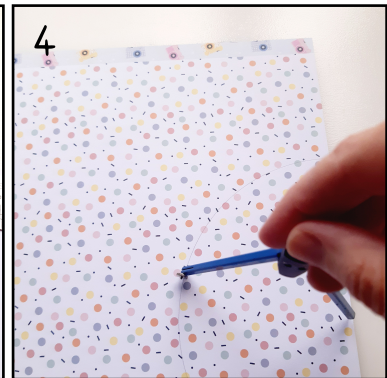

CLASS TWO: BIG CIRCLE BACKGROUNDS

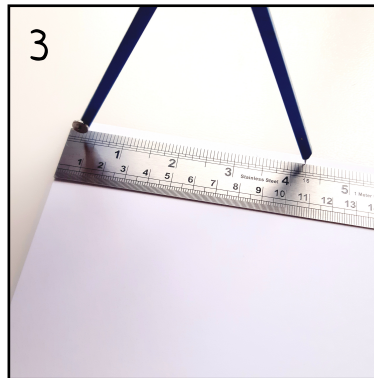
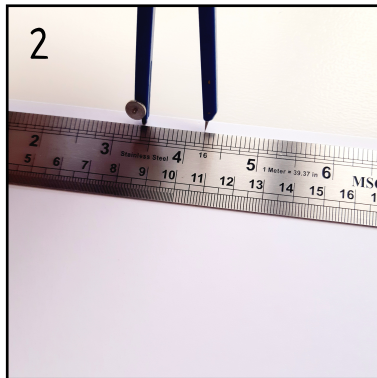
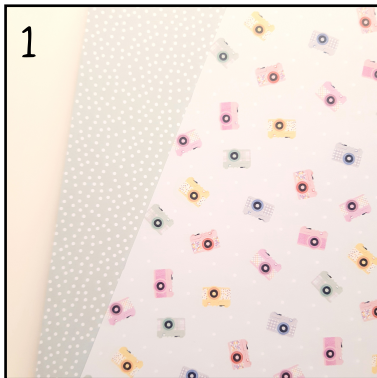

1 - Pick three patterned paper for your background and a sheet of plain white card for your base. I've cut my base to $8\frac{1}{2} \times 11$ inches because I'm making my page that size, you can cut yours to any size you want. This idea is adaptable to all page sizes. I'm using papers from the Lite kit they're all from the Rainbow Avenue collection, 'Sweet Love' 'Memory Keeper' and 'Playful Peonies'.

2 - Take a compass and a ruler. Place the ruler at the top of the page and put the point of the compass where the middle point of your page is.

3 - Move the compass out to the edge of your page keeping in the point in the middle.

4 - Keep the compass to that size and put the point on an edge of your patterned papers and draw three semi-circle pieces.

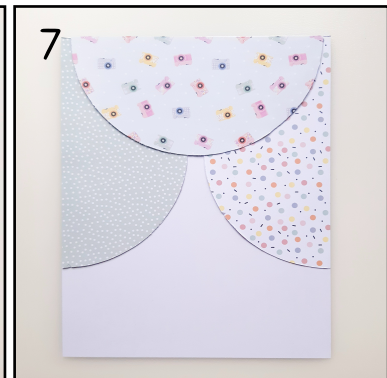
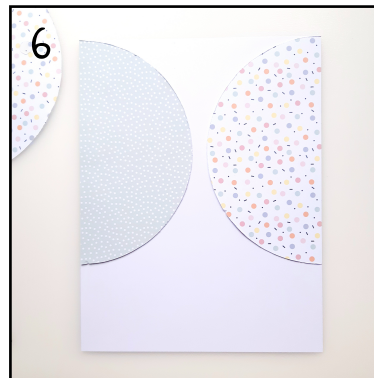

5 - Cut out the semi-circles from the patterned paper. I've distressed the edges of my cut out circles with the open edge of my scissors just for an extra bit of texture. It's also a good way to disguise slightly ropery hand cutting.

6 - Add two of the semi-circles to your background, one on the left, one on the right.

7 - Add the last semi-circle to the top layered over both. You can use this as a background to build your layout however you wish from here or carry on to make one exactly like mine.

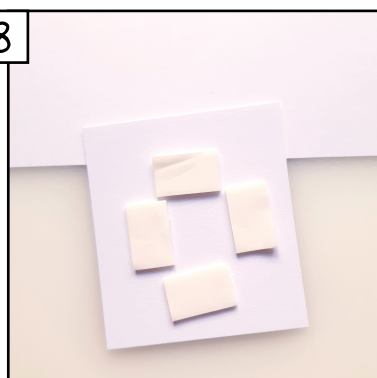

8 - Next I've added my photos. My layout uses quite a lot but you could narrow this down and use one or two. I've used 3D foam pads on the back of the photos so I have room to tuck ephemera underneath. The tickets I've stapled together before tucking underneath.



CLASS TWO: BIG CIRCLE BACKGROUNDS

9



9 - Next I've made my title using cut out patterned paper, (Rainbow Avenue 'Sweet Love'). An easy way to hand cut titles and make sure they fit your page is to first cut out rectangles of patterned paper and arrange them on your layout, trimming as needed then use these to cut out the letters keeping to the edges of the rectangles. I've outlined each letter with black pen then added a dash of colour colouring in some of the hearts with a yellow brush marker to pick out the yellow in my photos. For another part of my title I've cut out one of the journalling labels and used mini alphabet stickers on top. I've then added both titles to the lower half of the layout.



10 - As well as the Rainbow Avenue ephemera I've also cut out some more of the journalling spots and words from the Lite kit and used more of the Rainbow Avenue Sweet Love paper cut out in a circle to make another embellishment. I've used glue dots to fix them down to give a little bit of lift from the page.

Finished Layout:

